



STERO SUn

HOT AND COLD UNDERCOUNTER



STANDARD FEATURES

- 30 racks per hour rate – SUnH
- 30 racks per hour rate – SUnL
- .84 gallons of water per rack
- 1.5 minute cycle with optional extended cycle
- Hot water (SUnH) or chemical sanitizing (SUnL) units available
- Removable stainless steel scrap screen
- Chemical sensing indicators (low chemical alert)
- Booster heater capable of 70° rise (SUnH)
- Soft start
- Rinse Assurance ensures 180° final rinse (SUnH)
- Delime notification and cycle
- Chemical pumps standard
- Service diagnostics with error notifications
- Top-mounted user interface with digital temperature display
- Stainless steel Interchangeable upper and lower wash and rinse arms
- Pumped drain
- Pumped rinse
- 13.63" door opening
- Spring-assisted door
- Automatic tank fill
- Electric tank heat

OPTIONS & ACCESSORIES

- Stainless steel stand with rack storage and telescoping legs (legs in provide 15⁵/₁₆" of additional height; legs out provide 17⁷/₈" of additional height)
- 6" stainless steel leg kit
- Peg rack
- Combination rack
- Power cord kits
- One electrical connection is standard
- DWT – Drain water tempering kit

MACHINE RATINGS	SUnH Hot Water Sanitizing	SUnL Chemical Sanitizing
Racks per Hour Rate	30	30
Cycle Time – Seconds	90	90
Tank Heat	5.5 KW	2 KW
Electric Booster Heater	6 KW	N/A
Water Usage Per Rack – Gallons	.84	.84
Peak Drain Flow – Gallons per Minute	2.8	2.8
Incoming Water Temperature Required (minimum)	110°	120°

STERO SUn

HOT AND COLD UNDERCOUNTER



NOTICE

Required flowing water pressure to the dishmachine is at or above 20 PSIG. Pressure lower than 20 PSI may affect machine fill/start-up time. Pressure gauge not required on pumped rinse machines.

Important: Chemical containers should be placed no higher than 10" above floor. Unless incoming water is greater than 65 PSI.

If chemical containers are to be placed in cabinet adjacent to machine, a 1/2" dia. hole is required in the cabinet to run chemical supply line.

Use only 6% or 8.4% sodium hypochlorite (liquid bleach) as sanitizing chemical to insure proper operation of dishmachine (SUnL only).

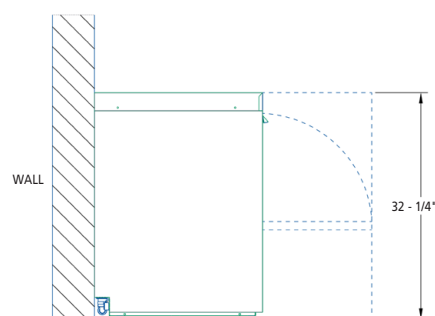

ADDITIONAL CLEARANCE REQUIRED TO SLIDE UNIT FORWARD FOR SERVICE ONLY

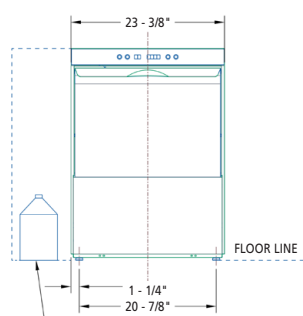
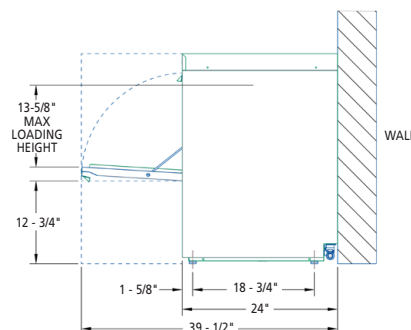

CHEMICAL BOTTLES MAY BE LOCATED ON EITHER SIDE OF MACHINE

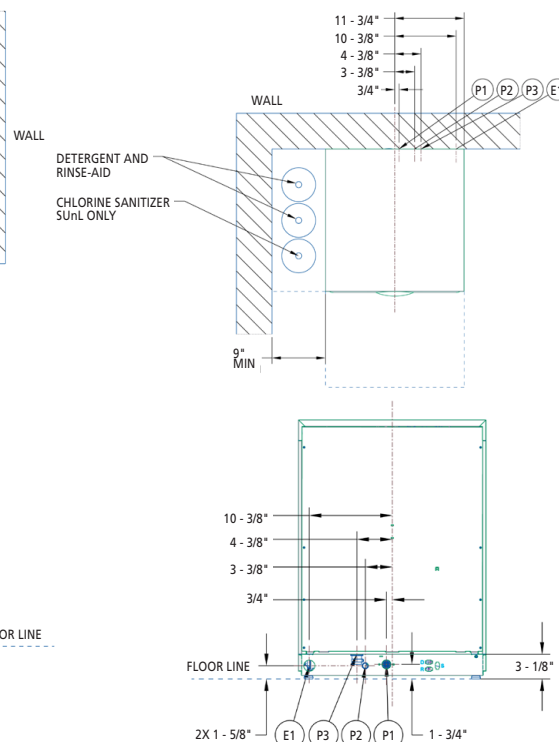

NOTES:

1. All vertical machine dimensions taken from floor may increase or decrease 1/2" depending on leg adjustment.
2. Moist air escapes from the door. Use only moisture resistant materials adjacent to dishmachine sides and top.
3. A vent hood is not recommended above the undercounter dishmachine since it does not produce excessive vapors.

PLUMBING NOTES:

1. Water hammer arrestor (meeting ASSE-1010 Standard or equivalent) to be supplied (by others) in common water supply line at service connection.
2. Recommended water hardness to be 3 grains or less for best results.
3. If drain hose is looped above a sink, the loop must not exceed 38" AFF.
4. Size of rack: 19-3/4" x 19-3/4"

WARNING

Electrical and grounding connections must comply with the applicable portions of the National Electrical Code and/or other local electrical codes.

Plumbing connections must comply with applicable sanitary, safety and plumbing codes. Drain and fill line configurations vary, some methods are shown on this drawing.

Do not premix other chemicals and sodium hypochlorite (liquid bleach). Mixing may cause hazardous gas to form. (SUnL only)

NOTE: Certain materials, including silver, aluminum and pewter are attacked by sodium hypochlorite (liquid bleach) in the chemical sanitizing dishwasher mode of operation. Water hardness must be controlled to 3 grains OR LESS for best results.

CONNECTION INFORMATION

(AFF = ABOVE FINISHED FLOOR)

LEGEND

- E1 ELECTRICAL CONNECTION: 1-3/8" DIA. HOLE FOR 1" TRADE SIZE CONDUIT; 1-5/8" AFF
- P1 SINGLE FILL AND RINSE CONNECTION: 3/4" FEMALE GARDEN HOSE FITTING ON 6' LONG HOSE SUPPLIED WITH MACHINE; 120F water minimum for SUnL, 140F water recommended.
- P2 DRAIN CONNECTION: 19MM O.D. BARB FITTING WITH 6' LONG HOSE SUPPLIED WITH MACHINE.
- P3 CHEMICAL SUPPLY: DETERGENT, SANITIZER AND RINSE AID: APPROX 1-5/8" AFF. 63" LONG, 6MM O.D. TUBING SUPPLIED WITH MACHINE.

MODEL	VOLTS/HERTZ/PHASE	RATED AMPS	MIN SUPPLY CKT CONDUCTOR AMPACITY	MAX PROTECTIVE DEVICE
SUnH	208-240/60/1	24.2/27.5	30	30
SUnL	120/60/1	17.5	20	20

NOTE: FOR SUPPLY CONNECTIONS, USE COPPER WIRE ONLY RATED AT 90°C MINIMUM
ACCESSORY CORD KIT AVAILABLE FOR ALL MODELS.

SHIPPING WEIGHTS		
MODEL	NET WEIGHT	DOMESTIC SHIPPING WEIGHT
SUnH	120 lbs.	148 lbs.
SUnL	120 lbs.	148 lbs.

OVERALL DIMENSIONS: 32-1/4" H x 23-3/8" W x 24" D